

HIGH-CLEARANCE T-HANGAR

Offered at \$225,000 · Available for Immediate Occupancy



Rare opportunity to own a high-clearance T-hangar at Bellingham International Airport. This unit delivers a true 14'8" clear span throughout - no pinch points, no compromise. If you've been trying to fit an amphib, a light twin, or anything with a tall vertical stabilizer into a standard T-hangar, you know how hard these units are to find.

Fits a variety of singles and twins, including Cessna 337 Skymaster, Beech Baron, Cessna 172/182/206/210, Cessna 310 and many others. The high clearance is perfect for amphibians or anyone looking for more breathing room!

The three-part sliding door provides smooth, easy access, and the finished floor offers a clean, sealed surface that's easy to keep up and pleasant to work on. Good overhead lighting and electrical service.

The hangar is vacant and ready for immediate occupancy.

The hangar is part of a condo structure on Port-owned land, with the land lease held through 2046. The condo association is responsible for exterior maintenance of the structure - you are responsible for interior maintenance.

Text, call or email to learn more. I am frequently on the field and am happy to show the unit to interested parties.

Michael Connolly
michael@connollyaviation.com

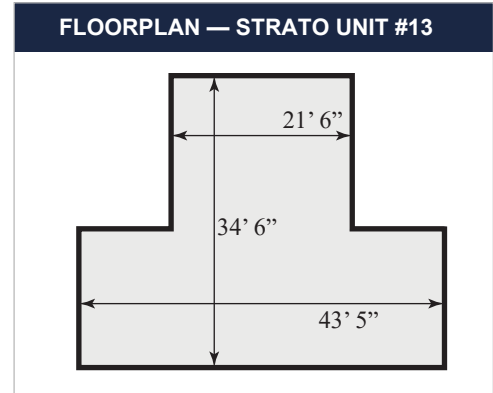

AIRCRAFT FOOTPRINTS

Cessna 337 	Beech Baron
Cessna 182 	Cessna 310

OWNERSHIP NOTES

Ownership:	Condo / fee simple unit
HOA:	Strato Condos association
Land Lease expires:	2046; held by Strato

WHY BELLINGHAM (KBLI)

- U.S. Customs Port of Entry
- Towered Airport with ILS / RNAV Approaches
- Fuel and Maintenance available onsite
- Gateway to San Juans & BC Gulf Islands